

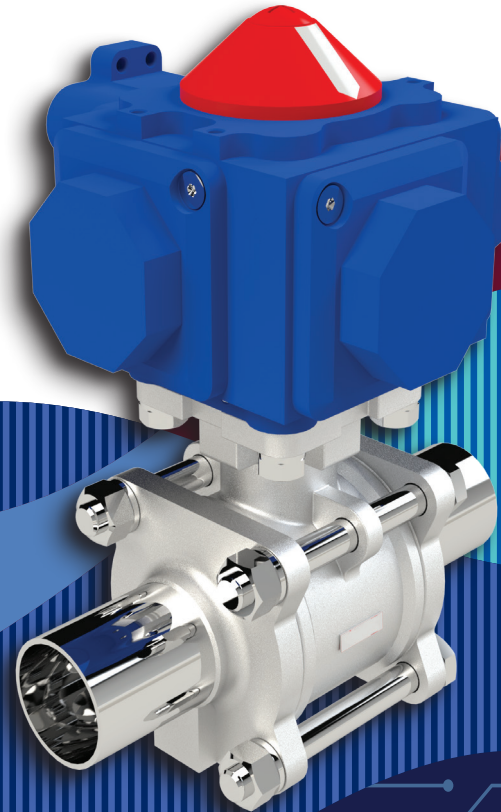

FLOW CONTROLS

Valves | Actuators | Controls

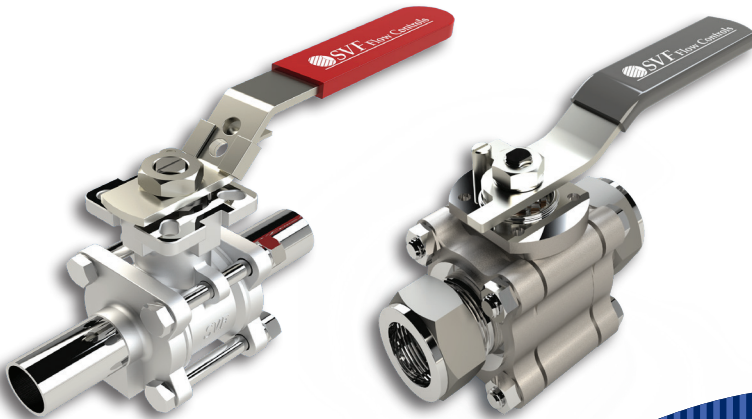

**SEMICONDUCTOR
SOLUTIONS**

SVF Flow Controls High Purity Valve Series

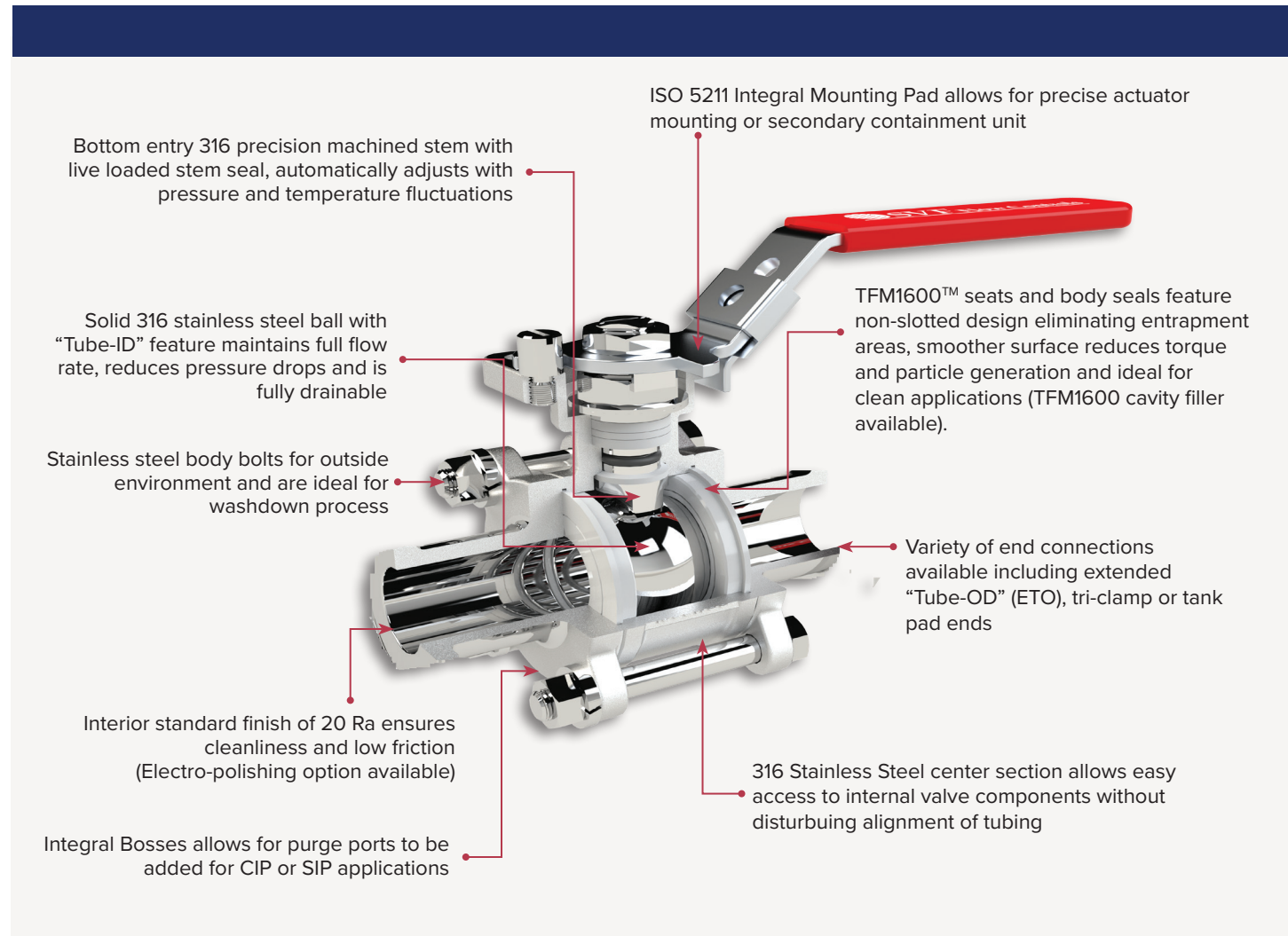

High Purity Valve Options



Options include:

- ▶ CFOS Cleaned and bagged
- ▶ Electropolishing
- ▶ Purge ports for flushing
- ▶ Stem extensions for line insulations
- ▶ Custom manifold designs
- ▶ Oval handle
- ▶ Additional sizes 1/4", 3/8", 6" and 8" are available upon request.

SVF Flow Controls High Purity Valve Series



The SVF Series SB9 High Purity Ball Valve is the newest member to our *CleanTECH™* family of high purity products. The SB9 is an ideal, competitively priced solution for manual and automated ball valve requirements in semiconductor.

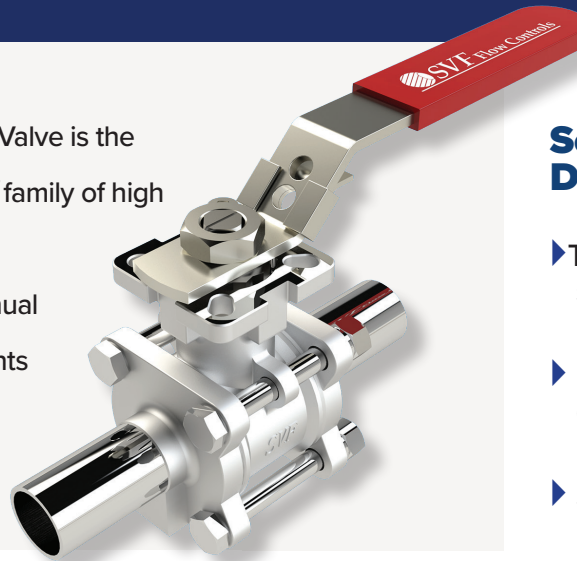

Series SB9 Design Features

- ▶ Three piece investment cast stainless steel
- ▶ "Tube-ID" flow path for drainability
- ▶ Standard interior finish is 20Ra or better
- ▶ Three-piece "swing out" design offers easy access for in-line maintenance
- ▶ Built-In ISO 5211 mounting pad for easy direct mount actuation
- ▶ Silicone Free
- ▶ Blow-out proof stem adds safety and reliability
- ▶ All materials comply with ASTM material specifications
- ▶ Live-loaded stem packing ensures seal-tight pressure containment even under thermal cycling
- ▶ End connections include Extended Tube O.D. (ETO ends with Boss for Purge Ports)

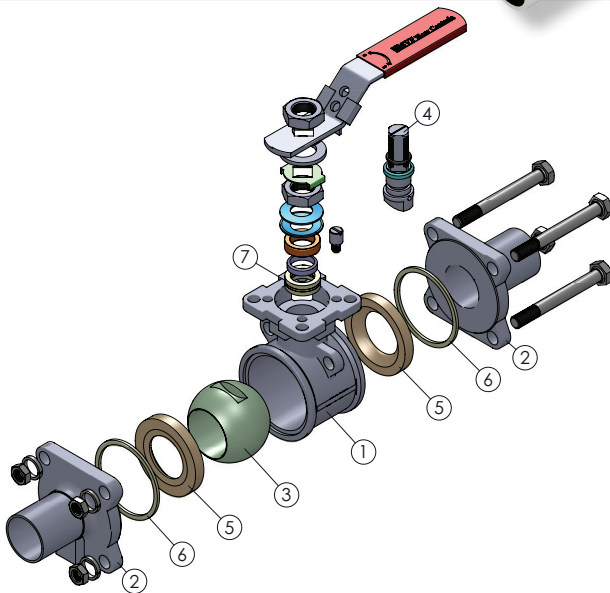

The Series SB9 Ball Valve is available with additional options.

Materials of Construction		
ITEM #	DESCRIPTION	MATERIALS SPECIFICATIONS
1	Body	316 Stainless Steel (ASTM A351 CF8M)
2	End Connector	316L Stainless Steel (ASTM A351 CF3M)
3	Ball	316 Stainless Steel (ASTM A351 CF8M)
4	Stem	316 Stainless Steel (SUS316)
5	Seat	TFM1600™
6	Body Seal	TFM1600™
7	Stem Seal	TFM1600™

SVF Flow Controls High Purity Valve Series



Dimensions, Weight, Cv, Torque

Size	A		B		D		L		W		Weight		Cv	Torque*	
	in.	mm	in.	mm	in.	mm	in.	mm	in.	mm	lbs	kg		in-lbf	Nm
1/2"	5.31	135	0.37	10	5.71	145	2.72	69	0.065	1.7	1	0.7	13	44	5
3/4"	5.59	142	0.62	16	5.71	145	2.99	76	0.065	1.7	2	0.9	18	53	6
1"	6.02	153	0.87	22	6.89	175	3.54	90	0.065	1.7	3	1.5	48	93	11
1-1/2"	7.05	179	1.37	35	7.68	195	4.06	103	0.065	1.7	5	2.2	120	195	22
2"	7.76	197	1.87	48	7.68	195	4.29	109	0.065	1.7	7	3.3	190	283	32
2-1/2"	8.90	226	2.37	60	10.43	265	5.79	147	0.065	1.7	18	8.4	450	434	49
3"	9.49	241	2.87	73	10.43	265	6.06	154	0.065	4.7	20	9.2	600	717	81
4"	10.94	278	3.84	98	15.75	400	8.07	205	0.083	2.1	30	13.5	1100	1080	122

SB9 - Pressure/Temperature Chart

* At full differential pressure for clean fluids

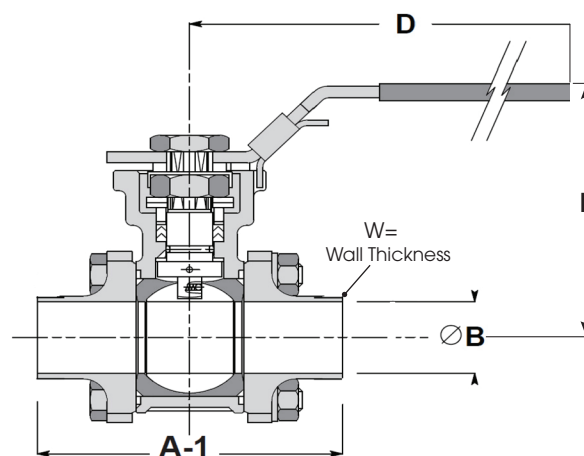
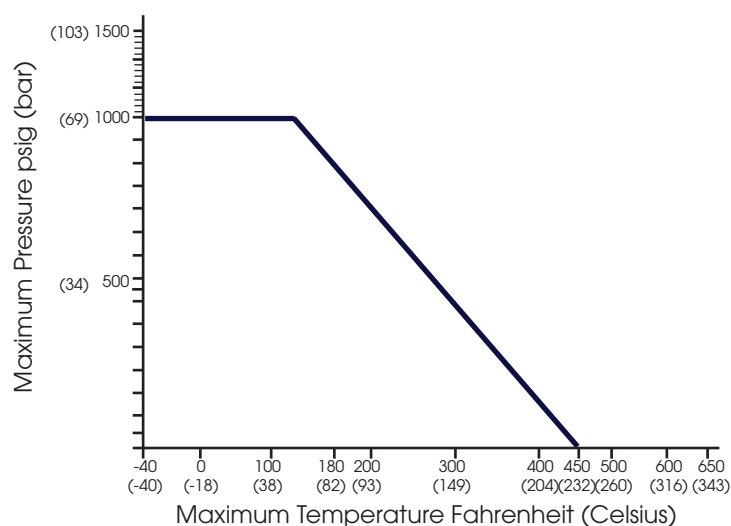

Actuators and Controls

Rack and Pinion Pneumatic Actuator	Quad4 Four Piston Pneumatic Actuator	E-Series Electric Actuator	NEXUS-LP/LPX Discrete Controller	EXACT XL / P3 Pneumatic / Electro-Pneumatic Positioner	VECTOR Series Pilot Valves

SVF Flow Controls Instrumentation Valve Series

The SVF Series L8 Ball Valves are compression-ended valves designed to be compatible with all of the leading instrument fittings. In addition to an integral ISO mounting pad, this high performance valve has a vast selection of seats and seals.

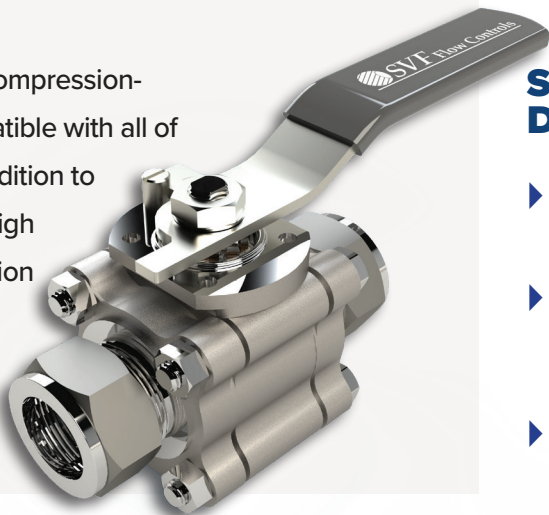

Series L8 Design Features

- ▶ High performance design for process-quality applications
- ▶ Compression ends are compatible with all leading instrument fittings
- ▶ Live-loaded stem seal ensures seal-tight pressure containment even under thermal cycling
- ▶ Three-piece “swing out” design offers easy access for in-line maintenance
- ▶ ISO 5211 mounting pad for easy actuation
- ▶ Standard seat material is TFM1600™
- ▶ Blowout proof stem adds safety & reliability

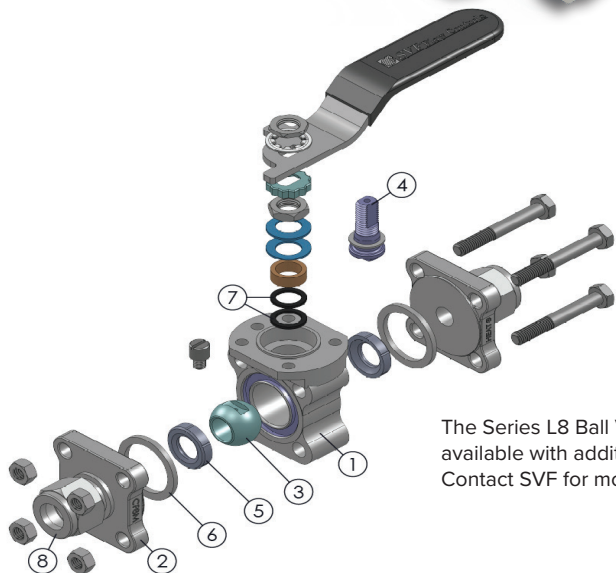

The Series L8 Ball Valve is available with additional options. Contact SVF for more information.

Materials of Construction		
ITEM #	DESCRIPTION	MATERIALS SPECIFICATIONS
1	Body	316 Stainless Steel (ASTM A351 CF8M)
2	End Connector	316L Stainless Steel (ASTM A351 CF3M)
3	Ball	316 Stainless Steel (ASTM A351 CF8M)
4	Stem	316 Stainless Steel (ASTM A276 316)
5	Seat	TFM1600™, Delrin®, SupraLon™, PEEK, PTFE, Buna “N”, SupraLon™, GRAFOIL®, Viton®, EPDM
6	Body Seal	SupraLon™
7	Stem Seal	SupraLon™
8	Compression Fittings	316 Stainless Steel with silver plated threads

Specification Standards of Compliance		
SVF Series L8 Ball Valves are available in designs that meet the following Industry Standards:		
ANSI	DIN	ASTM
ASME	ISO	NACE
API	MSS	
*Contact SVF for specific applications		

SVF Flow Controls Instrumentation Valve Series

Dimensions, Weight, Cv, Torque

Size	A		B		D		L		Weight		Cv	Torque* TFM1600™		Torque* SupraLon™		Torque* Delrin		Torque* PEEK	
	in.	mm	in.	mm	in.	mm	in.	mm	lbs	kg		in-lbf	Nm	in-lbf	Nm	in-lbf	Nm	in-lbf	Nm
1/4"	3.03	77	0.26	7	5.00	127	1.8	46	2	0.9	3	45	5	50	6	50	6	61	7
3/8"	3.11	79	0.38	10	5.00	127	1.8	46	2	0.9	5	45	5	50	6	50	6	61	7
1/2"	3.35	85	0.51	13	5.00	127	1.8	46	2	0.9	8	45	5	50	6	50	6	61	7
3/4"	3.74	95	0.76	19	5.00	127	1.9	48	2	0.9	12	45	5	50	6	60	7	130	15

L8 - Pressure/Temperature Chart

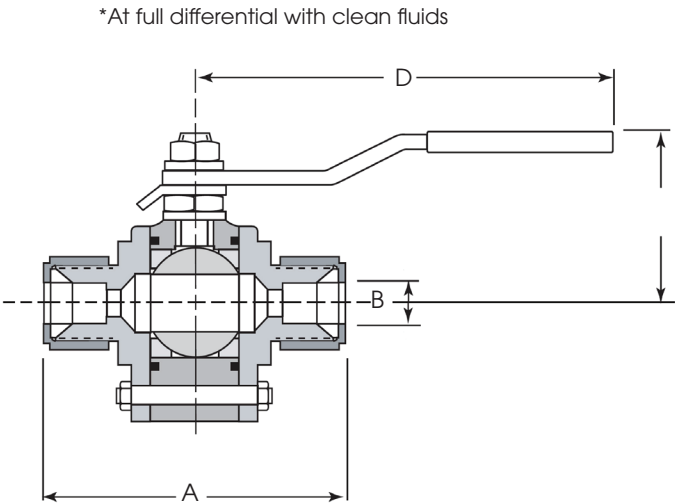
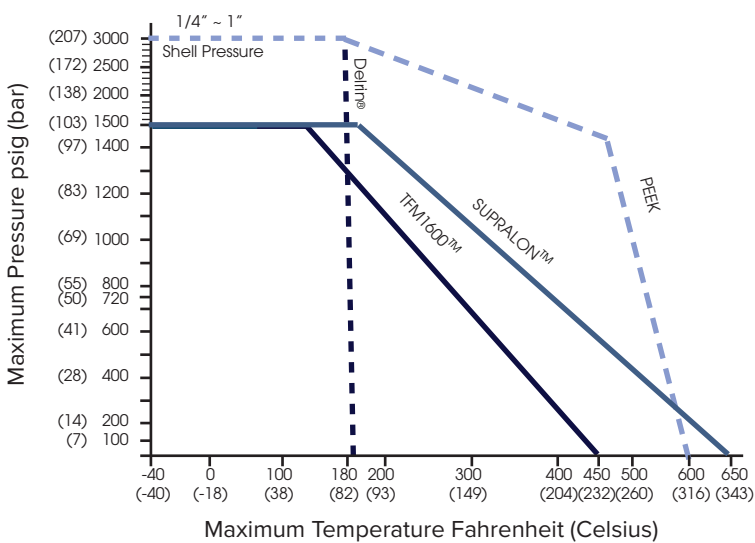

Class 1500 (Sizes: 1/4" to 1")
Note: Maximum pressure & temperature is limited to the seat material rating

Actuators and Controls

Rack and Pinion Pneumatic Actuator	Quad4 Four Piston Pneumatic Actuator	E-Series Electric Actuator	NEXUS-LP/LPX Discrete Controller	EXACT XL / P3 Pneumatic / Electro- Pneumatic Positioner	VECTOR Series Pilot Valves

SVF Flow Controls specializes in technical and engineering solutions, delivering actuators and controls to meet the demanding applications in the Semiconductor market.

- ▶ Helium leak tested (1×10^{-9} atm cc/sec)
- ▶ Live-loaded stem packing ensures seal-tight pressure containment even under thermal cycling
- ▶ Blow-out proof stem adds safety and reliability
- ▶ "Tube-ID" flow path for drainability
- ▶ Interior finish of 20Ra or better
- ▶ Silicone Free
- ▶ All materials comply with ASTM material specifications
- ▶ Testing Procedure: API 598
- ▶ Quality Management System: ISO-9001:2015

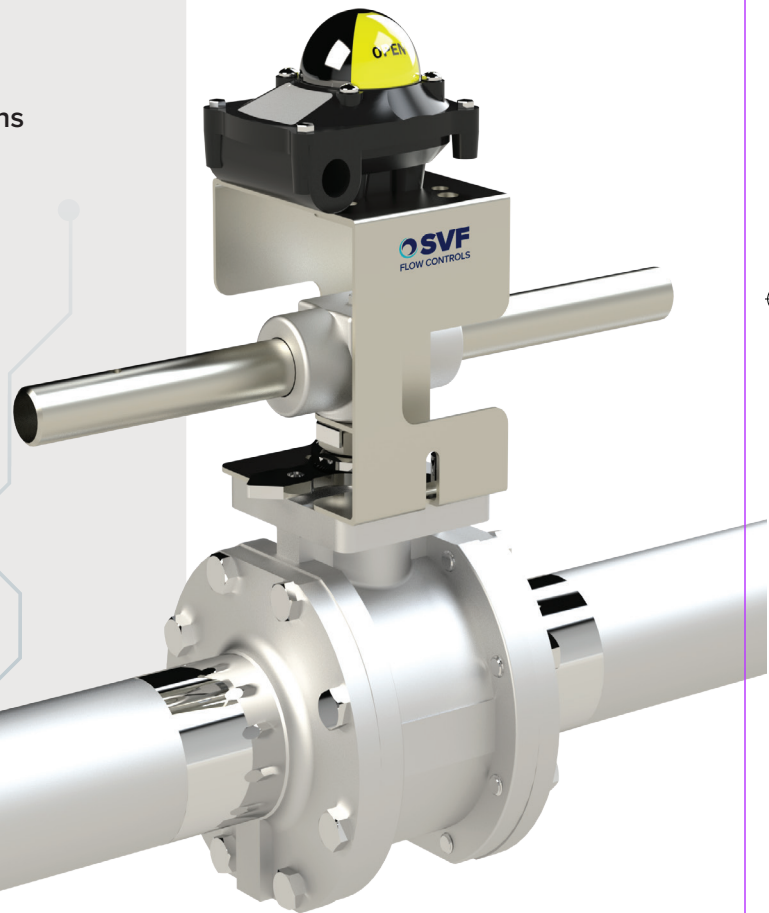

SVF Flow Controls takes excellence to a new level in the flow control marketplace.

Our extensive product range, highly knowledgeable staff, feature-rich website, digital initiatives and our ongoing customer-focused culture are all part of our role as the best supplier of valve and actuator technologies for demanding industries.

SVF products keep quality flowing all over the world in chemical, petro-chemical, power, pulp & paper, water/wastewater, oil & gas, refining, semiconductor, food & beverage, and pharmaceutical facilities and systems.

As an ISO 9001 certified company, we are committed to quality and continuous improvement in all that we do.

Don't see what you need? No problem! Custom designs and products created to meet exact specifications are our specialty. We welcome all inquiries and consultation needs, and guarantee that our team will work diligently to satisfy your requirements.

Product pricing and availability

U.S. and Canada:

Sales@SVF.net

Latin America:

LatinAmerica@SVF.net

¡Llámanos! ¡

Hablamos español!

Worldwide:

International@SVF.net

Technical Support:

Engineering@SVF.net

World Headquarters

SVF Flow Controls

5595 Fresca Drive, La Palma, CA USA 90623

Toll Free: 1.800.783.7836

On the web: www.SVF.net



Valves | Actuators | Controls



©SVF Flow Controls