

Series H7-62 Ball Valve

Three-Piece High Pressure Ball Valve

Sizes 3/4" ~ 1"



The SVF Series H7 Code 62 Standard Port High-Pressure ball valve is designed to meet applications up to 6000 psi. This performance engineered valve features a Stainless Steel Body and is available in a variety of alloy materials. The H7 adds safety and reliability to CNG high pressure systems.

SERIES H7 DESIGN FEATURES

- ✓ High performance design for process-quality applications
- ✓ High pressure ball valve up to 6000 psi
- ✓ Live-loaded stem seal ensures seal-tight pressure containment even under thermal cycling
- ✓ Three-piece "swing out" design offers easy access for in-line maintenance
- ✓ Standard seat material is Delrin
- ✓ Blowout proof stem adds safety & reliability
- ✓ Stainless steel fasteners and handle



The Series H7-62 Ball Valve is available with additional options. Contact SVF for more information.

MATERIALS OF CONSTRUCTION

ITEM	DESCRIPTION	MATERIALS SPECIFICATIONS
1	Body	316 Stainless Steel (ASTM A351 CF8M)
2	End Connector	SW/SE Ends 316L Stainless Steel (ASTM A351 CF3M) Code 62 Ends: 316 Stainless Steel (ASTM A351CF8M)
3	Ball	Stainless Steel 17-4 pH (ASTM A564 - 630)
4	Stem	17-4 pH Stainless Steel (ASTM A564 630)
5	Seat	Delrin [®] , PEEK
6	Body Seal	Buna "N", Viton [®] , EPDM
7	Stem Seal	Buna "N", Viton [®] , EPDM

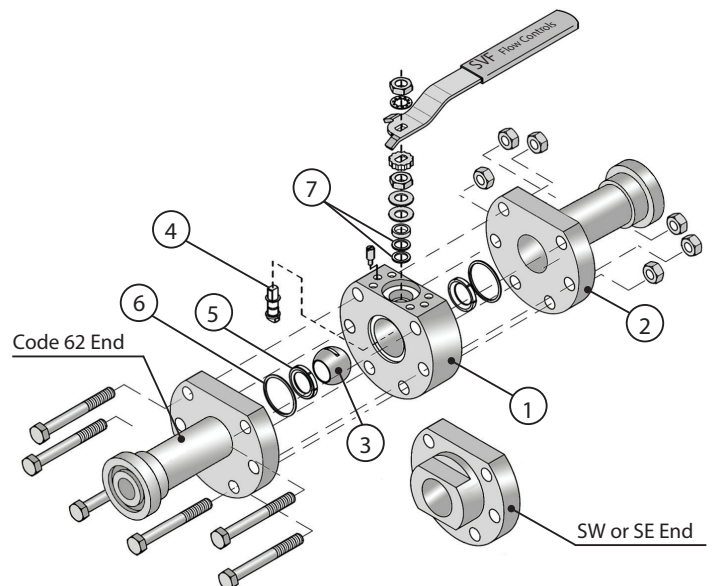

SERIES H7 NFPA-52 COMPLIANCE

SVF Series H7 Ball Valves have been third party pressure tested up to 4X according to NFPA-52

What do you need today?[™]



Series H7-62 Ball Valve

Three-Piece High Pressure Ball Valve

Sizes 3/4" ~ 1"



DIMENSIONS, WEIGHT, C_v, TORQUE

Size	A		B		D		L		Weight		C _v	Torque* Delrin		Torque* PEEK	
	in.	mm	in.	mm	in.	mm	in.	mm	lbs	kg		in-lbf	Nm	in-lbf	Nm
3/4" Code 62 X Code 62 End	8.12	206	0.56	14	5	127	1.9	48	6.2	2.8	12	200	23	220	25
3/4" Code 62 X SW/SE End	5.76	146	0.56	14	5	127	1.9	48	5.5	2.5	12	200	23	220	25
1" Code 62 X Code 62 End	8.75	222	0.81	21	6	152	2.4	61	11.8	5.3	32	300	34	330	37
1" Code 62 X SW/SE End	6.38	162	0.81	21	6	152	2.4	61	10.8	4.9	32	300	34	330	37

* At full differential pressure for clean fluids

H7-62 - PRESSURE/TEMPERATURE CHART

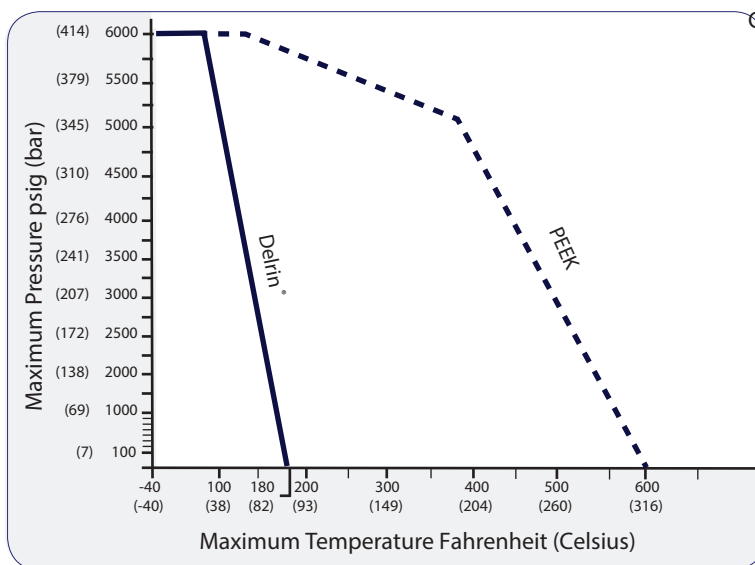

Class 2500

Note: Maximum pressure & temperature is limited to the seat material rating

Code 62 End X Code 62 End

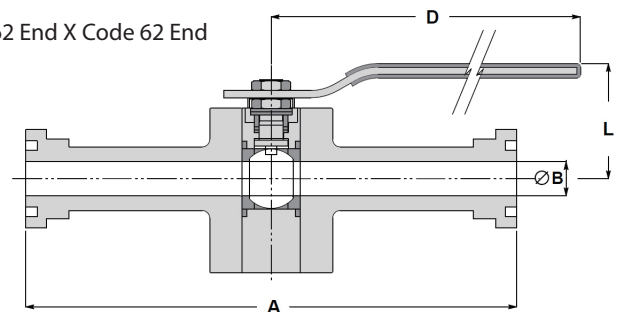

Code 62 End X SW/SE End

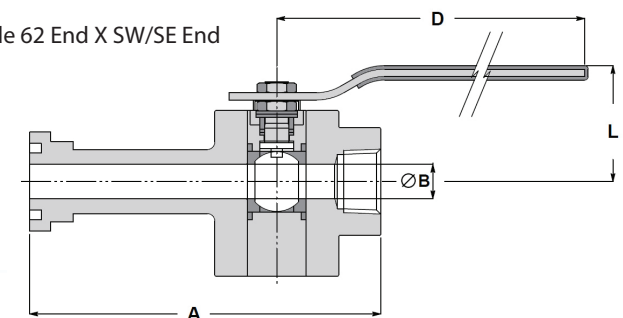

Series H7-62 Ball Valve

Three-Piece High Pressure Ball Valve

Sizes 3/4" ~ 1"



How To Order Guide (Columns 1 thru 11)

1	2	3	4	5	6
SERIES	BODY	ENDS	BALL	STEM	SEAT MATERIAL
H700	6 = 316 Stainless Steel ASTM A351 CF8M	6 = 316L Stainless Steel ASTM A351 CF3M (SW or NPT) or 316 Stainless Steel (ASTM A351 CF8M) Code 62	6 = 316 Stainless Steel ASTM A351 CF8M NOTE: Size 3/4" to 1" Valve requires 17-4 pH Ball	M = 17-4pH Stainless Steel ASTM A564 630	D = Delrin K = PEEK
7	8	9	10	11	
BODY SEAL	END CONNECTIONS	VALVE SIZE	OPTIONS*	SPECIAL SERVICES*	
B = Buna "N" V = Viton E = EPDM	UFA = Code 62 Ends AAH = Screwed End (FNPT) X Code 62 End (UFA) ABJ = Socket Weld End X Code 62 End (UFA)	007 = 3/4" 010 = 1"	00 = None LK = Locking Device AD = Anti-Static Device AC = Locking Device & Anti-Static Device	00 = None UH = Vent/Relief Hole ¹ HC = High Cycle Stem Kit	

Order Example: (H7006666DBUFA0070000) The Part Number will contain 20 digits.

Ordering Code Sequence >>

Sample Part Number >>

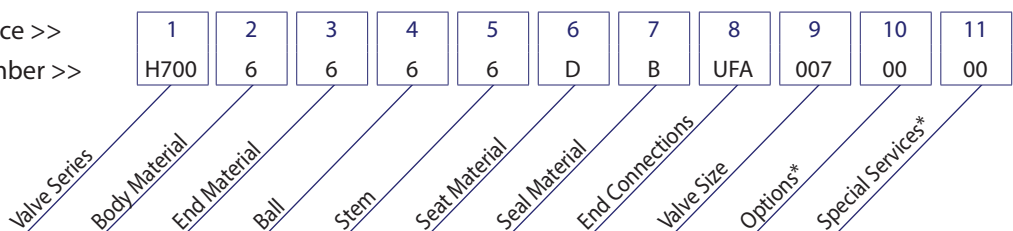

¹ Vent Hole is on the Upstream Side

*Not all Options or Special Services available on all ball valves. Consult SVF for additional information.